

# K-SCHLAUCHTUELLEN MS

Hose fittings

**HANSA FLEX**

## 属性

工作压力	10 bar
介质温度	max. +90 °C
环境温度	Max. +90 °C
原料	黄铜

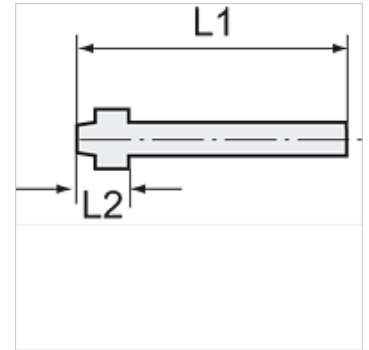
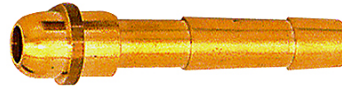

## 提示

The dimensions of the standard screw fittings may change slightly during the life of the catalogue as a result of optimisation processes. 其它数据应客户要求提供。

## 附加信息

Further types and dimensions on request.

## 货品

名称	用于软管	用于锁紧螺母	L1 (mm)	L2 (mm)
K- 07 40 16 61	LW 4 mm	G 1/8	47,0	12,0
K- 07 40 16 52	LW 4 mm	G 1/4	47,0	13,5
K- 07 40 16 54	LW 9 mm	G 1/4	47,0	13,5
K- 07 40 16 55	LW 4 mm	G 3/8	48,5	15,0
K- 07 40 16 58	LW 6 mm	G 1/2	48,5	15,0
K- 07 40 16 60	LW 13 mm	G 1/2	48,5	15,0