

K-3/2-BKR MULTIFIX MINI

Ball valves

HANSA FLEX

属性

介质温度	max. 60 °C
环境温度	Max. 60 °C
操纵件	Twist knob, rotatable 90°
流量	1800 l/min
排气接口	Silencer G 1/4
密封材料	NBR
壳体	Die-cast zinc
流量值测量	At P1 = 6 bar and pressure drop $\Delta p = 1$ bar

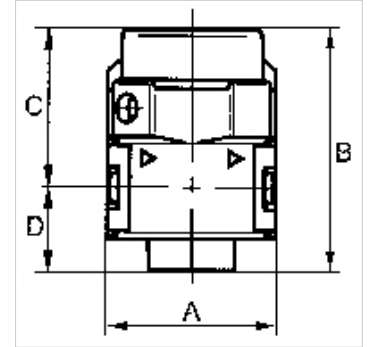
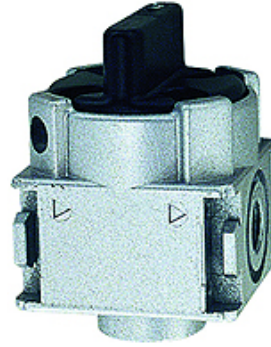

提示

If several devices in the »multiflex-mini« Series are assembled together, the maximum working pressure is 12 bar.
其它数据应客户要求提供。

描述

Rotary switch can be turned 90°, lockable, with relief port

货品

名称	螺纹	A (mm)	B	C (mm)	D (mm)	结构尺寸
K- 07 25 11 56	G 1/8	40,0	57,6 mm	37,6	20,0	0
K- 07 25 11 57	G 1/4	40,0	57,6 mm	37,6	20,0	0

备件

K-KOPPELPAKET MEHR	Coupling packet
K-AUTOMAT ABLASSVENTIL	Automatic drain valve
K-SCHALLDAE SINTERBR SCHLITZ	Silencers, sintered bronze, slotted