

K-BKR KL SERIE 374

Ball valves, 374 series

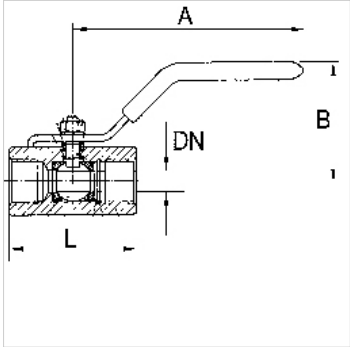

属性	
工作压力	max. 70 bar (Depending on Temperature)
工作温度	Max. 150 °C
密封	PTFE
手柄	Stainless steel 1.4301



提示

G thread acc. to DIN EN ISO 228-1, with ISO flange plate (acc. to ISO 5211)
其它数据应客户要求提供。

订购指南

For use on devices that have to be vented whenever they are turned off, either because of safety regulations or for technical reasons. The pneumatic devices are disconnected from the system and simultaneously vented each time they are shut off.

附加信息

G thread acc. DIN EN ISO 228-1

货品

名称	DN	螺纹	A (mm)	B (mm)	L (mm)	原料
K- 07 30 15 32	5	G 1/4	62,0	30,0	47,0	Stainless steel 1.4401/1.4408
K- 07 30 15 33	7	G 3/8	82,0	30,0	51,0	Stainless steel 1.4401/1.4408
K- 07 30 15 34	9	G 1/2	92,0	45,0	64,0	Stainless steel 1.4401/1.4408
K- 07 30 15 35	13	G 3/4	94,0	50,0	68,0	Stainless steel 1.4401/1.4408