

K-HS PTFE DICHTRING EINFACH

Banjo bolts with PTFE seal, single

HANSA FLEX

属性

脉冲工作压力	Max. 10 bar
压力	Max. 15 bar (depending on pipe quality)
合适的管件材料	PVDF, PTFE, stainless steel, PA, PU
标准	G thread acc. to DIN EN ISO 228-1
环境温度	-20 °C to max. +150 °C (depending on pipe quality and diameter)
原料	不锈钢 1.4404
密封材料	FKM

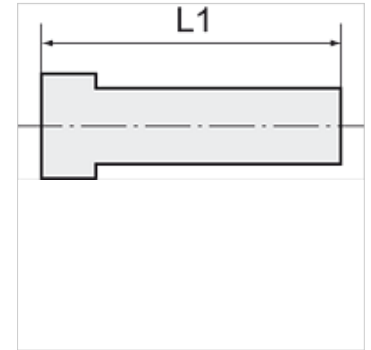
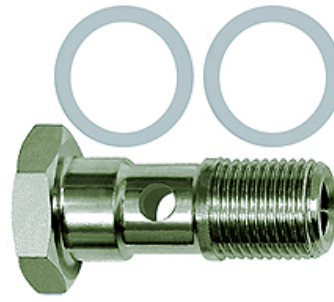

提示

其它数据应客户要求提供。

描述

For use with aggressive media and in areas with corrosive outside influences, in the food processing industry and in hygienic and sanitary applications.

货品

名称	螺纹	L1 (mm)	SW
K- 07 40 47 04	G 1/8	29,0	14 mm
K- 07 40 47 03	G 1/4	32,5	17 mm
K- 07 40 47 05	G 3/8	36,0	21 mm
K- 07 40 47 02	G 1/2	41,5	26 mm