

K-VHR IS BUND ES

Hexagon socket screw plugs with collar

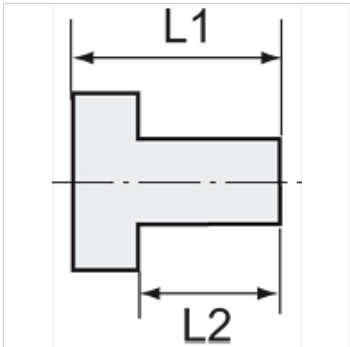

属性	
工作压力	Max. 20 bar
结构类型	内六角闭锁螺钉
原料	不锈钢 1.4571

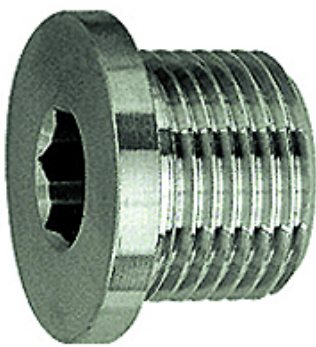

提示
The dimensions of the standard screw fittings may change slightly during the life of the catalogue as a result of optimisation processes.
其它数据应客户要求提供。

附加信息
Further types and dimensions on request.

货品				
名称	螺纹	L1 (mm)	L2 (mm)	SW
K- 07 40 39 65	G 1/8	11,0	8,0	5 mm
K- 07 40 39 66	G 1/4	13,0	10,0	6 mm
K- 07 40 39 67	G 3/8	15,0	12,0	8 mm
K- 07 40 39 68	G 1/2	18,0	14,0	10 mm
K- 07 40 45 22	G 3/4	20,0	16,0	12 mm
K- 07 40 45 25	G 1	21,0	16,0	17 mm