

K-GABELKOEPFE 4

Fork model

HANSA FLEX

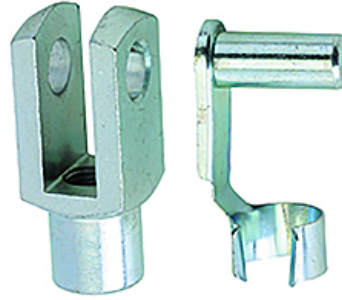

货品

名称	活塞直径 Ø	规格	活塞杆螺纹
K- 07 15 21 97	25 mm / 32 mm / 32 mm / 32 - 40 mm / 25 mm	With hinged spring pin	M 10 x 1.25
K- 07 15 21 98	40 mm / 40 mm / 50 - 63 mm	With hinged spring pin	M 12 x 1.25
K- 07 15 22 00	80 - 100 mm	With hinged spring pin	M 20 x 1.5
K- 07 15 22 01	125 mm	With two snap rings	M 27 x 2

是下述产品的附件

K-RUNDZYLINDER DOPP O E D	Round cylinders, double acting, magnetic, non-cushioned
K-RUNDZYLINDER DOPP O D	Miniature cylinders, double acting (magnetic, non-cushioned)
K-RUNDZYLINDER EINF O D	Miniature cylinders, single-acting (magnetic, non-cushioned)
K-RUNDZYLINDER DOPP O D 1	Round cylinders, double acting (magnetic, non-cushioned)
K-NORMZYLINDER	Standard cylinders