

K-MV G (NC) D 230 V, 50 HZ H 1

Normally closed, (NC), directly operated, 230 V, 50 Hz, for high pressures

HANSA FLEX

属性

电接口	device socket type A in acc. with ISO 4400 for all valves with threads G 3/8 & G 1/2, except valves type 3 & 4. Device socket
螺纹描述	G thread acc. DIN EN ISO 228-1
介质温度	max. 80 °C when using water or oils; max. 90 °C when using with air
保护等级	IP 65
最大工作压力	30 bar
密封材料	FPM
壳体, 阀座	Stainless steel 1.4301
内部部件	Stainless steel

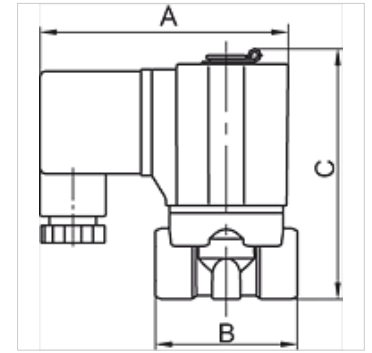

提示

其它数据应客户要求提供。

描述

Standard series in two different versions: Directly operated, Pilot-operated

货品

名称	螺纹	NW	A (mm)	B (mm)	C (mm)	结构形式
K- 07 30 01 16	G 1/8	1,5	70,0	40,0	70,7	1
K- 07 30 01 17	G 1/4	1,5	70,0	40,0	70,7	1
K- 07 30 01 18	G 3/8	3,0	85,0	52,0	87,0	1
K- 07 30 01 19	G 1/2	3,0	85,0	52,0	87,0	1