

K-UEM MS NI

Hexagonal swivel nuts - nickel plated brass

HANSA FLEX

属性

工作温度	Max. 150 °C
压力	Max. 60 bar
原料	黄铜镀镍

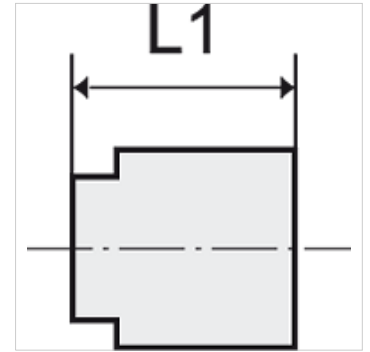
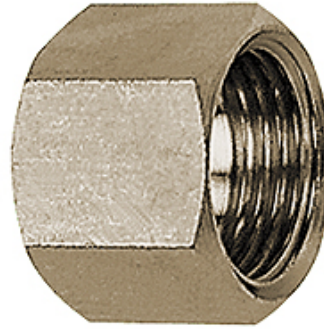

提示

The dimensions of the standard screw fittings may change slightly during the life of the catalogue as a result of optimisation processes. 其它数据应客户要求提供。

描述

Suitable for air, water, oil, steam, etc.

附加信息

Further types and dimensions on request.

货品

名称	螺纹	用于套管尺寸	L1 (mm)	SW
K- 07 40 44 22	G 1/8	I.D. 4, I.D. 6	13,0	14 mm
K- 07 40 44 23	G 1/4	I.D. 4, I.D. 6	15,0	17 mm
K- 07 40 44 24	G 3/8	I.D. 9	15,0	19 mm
K- 07 40 44 25	G 1/2	I.D. 4, I.D. 6, I.D. 9	16,0	24 mm