

K-L-STECKVER ABSP DREH AG-K

Angle stop valves, swivel type, conical male thread, coated

属性	
工作压力	Max. 10 bar, vacuum
应用范围	Air, vacuum
推荐的软管	PU or PA (nylon)
适用介质	压缩空气
标准	R thread acc. to ISO 7-1, thread coating
温度范围	0 °C to +60 °C
密封面	Conical version: thread coating
原料	Plastic, Nickel plated brass
紧压环	Plastic

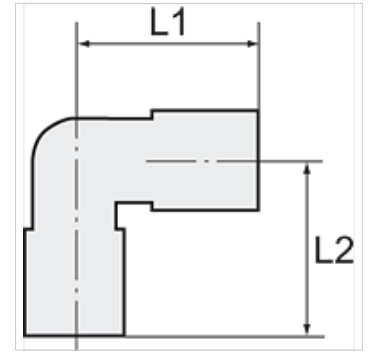

提示

其它数据应客户要求提供。

描述

The air supply is completely shut off as soon as the hose is disconnected from the union.
The flow rate is only guaranteed if the hose is securely inserted.

货品

名称	螺纹	用于软管外径-Ø	L1 (mm)	L2 (mm)	SW
K- 07 40 08 53	R 1/8	4 mm	31,0	23,8	10 mm
K- 07 40 08 54	R 1/8	6 mm	29,4	24,2	12 mm
K- 07 40 08 55	R 1/8	8 mm	33,0	27,5	14 mm
K- 07 40 08 51	R 1/4	6 mm	29,4	26,7	14 mm
K- 07 40 08 52	R 1/4	8 mm	33,0	29,5	14 mm
K- 07 40 08 50	R 1/4	10 mm	42,5	34,3	17 mm
K- 07 40 08 58	R 3/8	8 mm	33,0	31,0	17 mm
K- 07 40 08 56	R 3/8	10 mm	42,5	35,3	17 mm
K- 07 40 08 57	R 3/8	12 mm	46,5	37,0	21 mm
K- 07 40 08 48	R 1/2	10 mm	42,5	38,8	21 mm
K- 07 40 08 49	R 1/2	12 mm	46,5	40,0	21 mm