

K-RD STUECKE PP

Reducers

HANSA FLEX

属性

工作压力	on request
工作温度	Max. +20 °C
原料	Polypropylene (PP)
密封材料	NBR

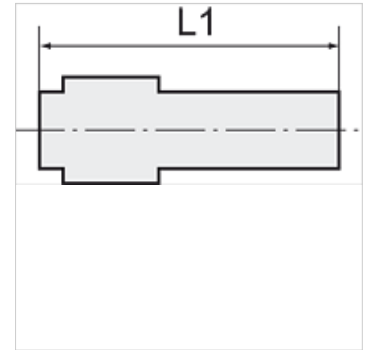

提示

其它数据应客户要求提供。

描述

Lightweight, push-in fittings distinguished by high strength, toughness, resistance to abrasion and impact resistance - ideal for a wide range of applications. Plastic and metal tubes are connected together quickly and easily. Suitable for compressed air or liquids, with good resistance to a large number of chemicals.

货品

名称	用于软管外径-Ø	L1 (mm)	接套 (mm)
K- 07 40 29 00	22 mm	127,0	32
K- 07 40 29 01	28 mm	133,3	32