

# K-T-STECK VERS ISK DREH AG OR1

Male branch tees with inner hex, swivel type, parallel male thread with O-ring

**HANSA FLEX**

## 属性

工作压力	Max. 15 bar, coarse vacuum
应用范围	Air, vacuum
推荐的软管	PU or PA (nylon)
适用介质	Compressed air and all gases or liquids that are compatible with the materials
温度范围	-20 °C to +80 °C
密封面	Parallel version: O-ring in housing
原料	Plastic, Nickel plated brass
紧压环	Plastic

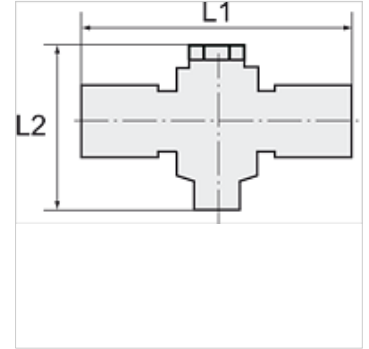

## 提示

其它数据应客户要求提供。

## 描述

Push-in fittings series manufactured in plastic and nickel-plated brass. All parts are suitable for use with hoses, tubes or pipes made of plastic and copper.

## 货品

名称	螺纹	用于软管外径-Ø	内六角 (mm)	L1 (mm)	L2 (mm)	SW
K- 07 40 06 21	G 1/8	4 mm	4,0	45,0	28,5	14 mm
K- 07 40 06 22	G 1/8	6 mm	4,0	42,6	28,5	14 mm
K- 07 40 06 23	G 1/8	8 mm	4,0	48,5	28,5	14 mm
K- 07 40 06 19	G 1/4	6 mm	6,0	46,7	37,5	17 mm
K- 07 40 06 20	G 1/4	8 mm	6,0	52,5	37,5	17 mm
K- 07 40 06 17	G 1/4	10 mm	6,0	59,6	37,5	17 mm
K- 07 40 06 18	G 1/4	12 mm	6,0	60,7	37,5	17 mm
K- 07 40 06 26	G 3/8	8 mm	8,0	56,3	39,2	20 mm
K- 07 40 06 24	G 3/8	10 mm	8,0	63,5	39,2	20 mm
K- 07 40 06 25	G 3/8	12 mm	8,0	64,9	39,2	20 mm