

K-DRG PNEU FERNGEST MULTIFIX

Pressure regulators with pneumatic remote control

HANSA FLEX

属性

入口压力	Max. 16 bar
出口压力	corresponds to the set pressure of the pilot pressure regulator
介质温度	max. 60 °C
环境温度	Max. 60 °C
密封材料	NBR
壳体	Die-cast zinc, Aluminium for G 1 variant
流量值测量	At P1 = 8 bar, P2 = 6 bar and pressure drop $\Delta p = 1$ bar
操作空气接口	G 1/8

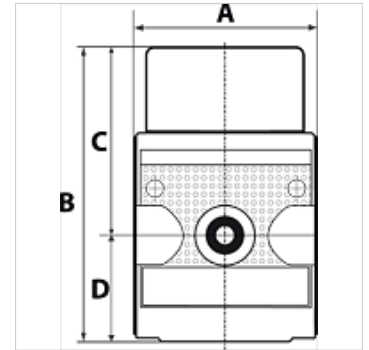

提示

其它数据应客户要求提供。

描述

Diaphragm pressure regulator, self-relieving, with pneumatic remote control. The pressure is set with a pilot pressure regulator (1:1 ratio). Either a standard or a precision pressure regulator can be used to regulate the pilot pressure.

货品

名称	螺纹	流量 (L/min)	A (mm)	B	C (mm)	D (mm)
K- 07 25 19 56	G 1/4	1800	48,0	75,0 mm	48,0	27,0
K- 07 25 19 57	G 1/2	4800	69,0	94,0 mm	59,0	35,0
K- 07 25 19 58	G 1	12500	100,0	112,0 mm	60,0	52,0

备件

K-HALTERBAUSATZ MULTIFIX	Holder
K-KOPPELPAKET MEHR	Coupling packet
K-VERSCHLEI-SATZ MULTIFIX	Set of wearing parts »multifix«